

 <p>Industrial &amp; Electrical Components</p>	<h1>Automotive Relay</h1>	<p>Part No. <b>NRA01</b></p>
---	-------------------------------	------------------------------

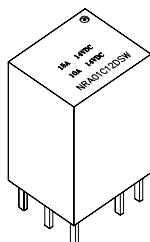

Switching capacity 15A in small size  
 Automobile control box or Alarm system  
 Low cost and high performance.  
 With or without Dust cover available.

### CONTACT

Arrangement	1A,1B,1C / 1SA, 1SB, 1SC
Contact Material	Silver Alloy
Contact Resistance	
(By voltage drop 6V 1A)	Max. 100mΩ
Rating	
Resistive load	15A 14VDC
(Cos.Φ=1)	10A 14VDC
Motor Inrush	
Max. Allowable Voltage	75VDC
Max. Allowable Current	20A
Max. Allowable Power	200W
Service life	
Electrical	1 X 10 <sup>5</sup>
Machanical	1 X 10 <sup>6</sup>

### CHARACTERISTICS

Operate Time	5ms
Release Time	3ms
Initial breakdown voltage	
Between coil & contact	500VAC for 1 Min.
Between open contacts	500VAC for 1 Min.
Insulation Resistance	Min.100MΩ (500 VDC)
Ambient temperature	-40 ~+85
Humidity	40~85%
Shock	Functional 10G
Resistance	Destruction 100G
Vibration	Functional 10 to 55 Hz D.A. of 2mm
Resistance	Destruction 10 to 55 Hz D.A. of 2mm
Unit weight	9.5g Max.

### ORDERING INFORMATION

e.g

**NRA - 01 - C - 12D - S**

Series: NCR Automotive Relay Series

Part No.

Contact Form: C=1C/O; A = N/O; B= N/C

SC=Dual C/O; SA =Dual N/O; SB= Dual N/C

Coil Voltage: 6, 9, 12, 24 dc

S= Sealed type K= Open type (without cover)

**COIL DATA (at 20 )**

Nominal Voltage (VDC)	Pick-up Voltage VDC(Max)	Drop-out Voltage VDC(Min)	Coil Resistance ( $\Omega$ ) $\pm 10\%$ 1.1W	Max. Allowable Voltage
6	3.90	0.30	28	130% apply to nominal Voltage
9	5.90	0.45	70	
12	7.80	0.60	130	
24	15.6	1.20	520	

**DIMENSIONS (Unit: mm)**

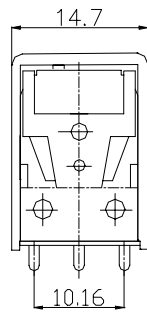
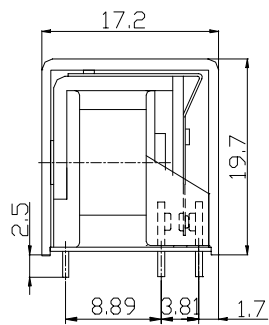

(BOTTOM VIEW)

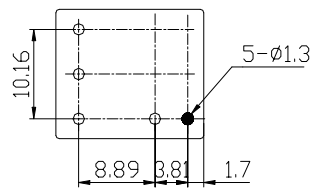

(BOTTOM VIEW)

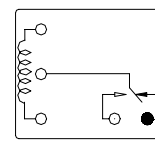

**NRA-01-C-xx**

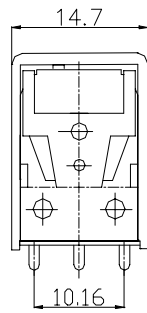
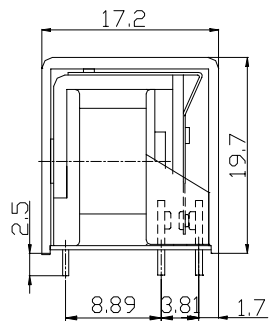

(BOTTOM VIEW)

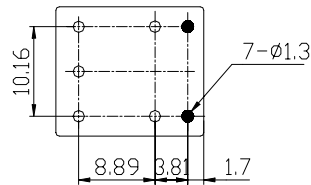

(BOTTOM VIEW)

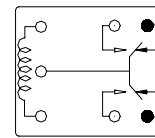

**NRA-01-SC-xx**

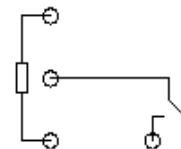

**NRA-01-A-xx**



Industrial & Electrical Components

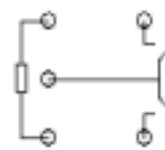

**NRA-01-SA-**